

DS 26 series

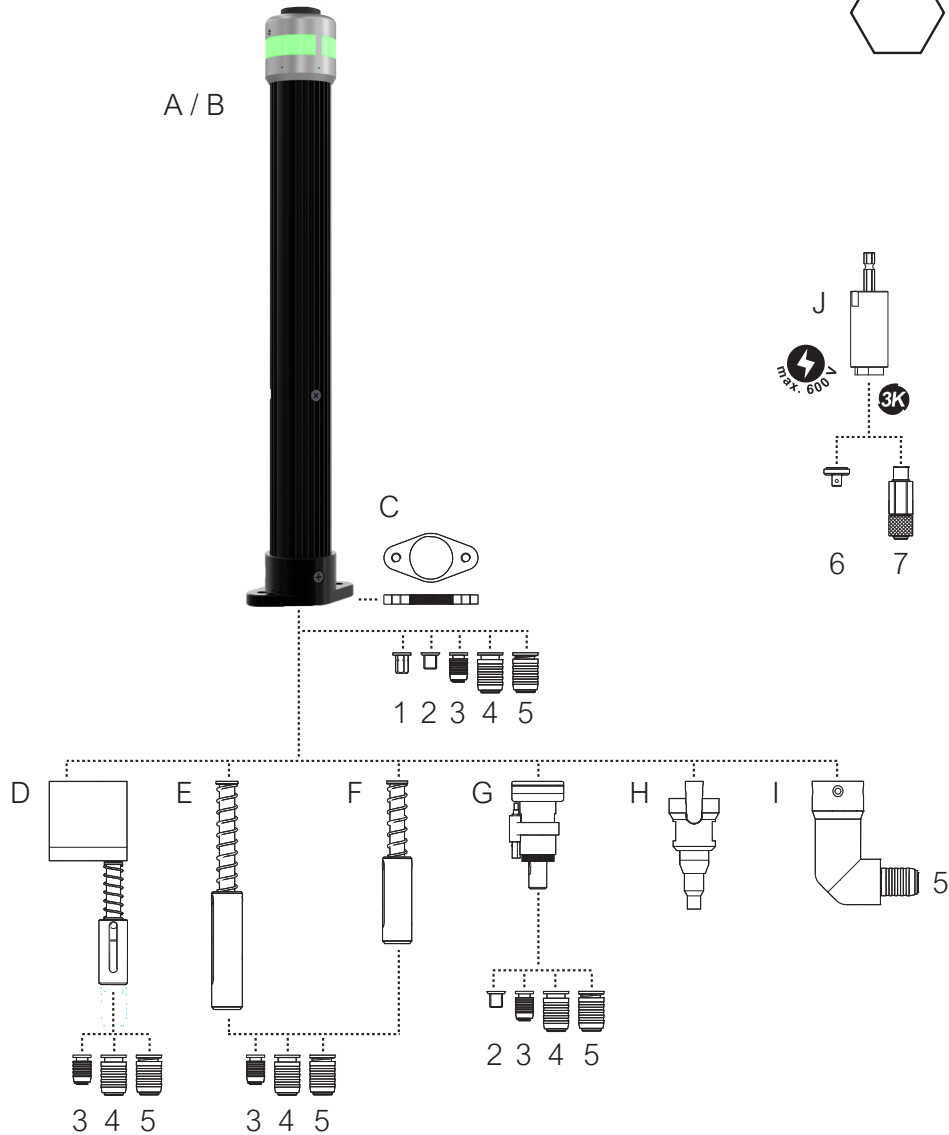
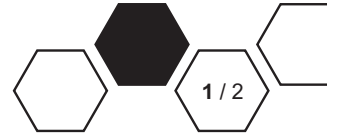

A DS 26 MDW with torque transducer

Type	Max. torque	Application area	Max. speed	Angle resolution	Article number
DS 26 / 005 MDW	0,5 Nm	0,05 - 0,5 Nm	1450 rpm	3,7 °	DS-2260005
DS 26 / 01 MDW	1 Nm	0,2 - 1 Nm	1450 rpm	3,7 °	DS-2260010
DS 26 / 02 MDW	2 Nm	0,4 - 2 Nm	1020 rpm	2,6 °	DS-2260020
DS 26 / 04 MDW	4 Nm	0,8 - 4 Nm	400 rpm	1,0 °	DS-2260040

Torque accuracy 0,5 %, torque tolerance better 5 % according to ISO 5393

B DS 26 SA without torque transducer (current controlled)

Type	Max. torque	Application area	Max. speed	Angle resolution	Article number
DS 26 / 005 SA	0,5 Nm	0,05 - 0,5 Nm	1700 rpm	4,3 °	DS-2261005
DS 26 / 01 SA	1 Nm	0,2 - 1 Nm	1700 rpm	4,3 °	DS-2261010
DS 26 / 02 SA	2 Nm	0,4 - 2 Nm	820 rpm	2,1 °	DS-2261020
DS 26 / 04 SA	4 Nm	0,8 - 4 Nm	400 rpm	1,0 °	DS-2261040

Torque accuracy depends on the adjustment of the nutrunner

DS 26 series

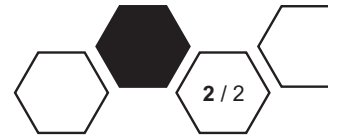

C Mounting flange

Type	Article number
Mounting flange	DS-2263000

E / F Spring output

Type	Article number
Spring output 20 mm	DS-2263010
Spring output 50 mm	DS-2263015

H Vacuum screw-retainer

Type	Article number
With electric supply unit	DS-2263895
With pneumatic supply unit	DS-2263896

1 Hexagon drive 1/4"

Type	Article number
Hexagon drive 1/4"	DS-2263725

3 Hexagonal quick release element B3

Type	Article number
Hexagonal quick release element B3	DS-2263720

5 Hexagonal quick release element D6,3

Type	Article number
Bit shaft precision-guide 13 mm	DS-2263705
Bit shaft precision-guide 24 mm	DS-2263710

J Output unit with galvanic isolation

Type	Article number
Output unit 1/4"_24mm-GT-3K	DS-2403735
In: 1/4" hex 24 mm length, DIN3126 - E6,3	
Out: DSM 3K	

6 Square drive 1/4"

Type	Article number
Square drive 1/4" (3K insert)	DS-2403715

D Output offset (max. 2 Nm)

Type	Article number
Output offset V1	DS-2263005

G Self start output

Type	Article number
Self start with 5 mm spring deflexion	DS-2263020

I Angle head

Type	Article number
Angle head (D6,3); Gear ratio 1:1	DS-2263025
Torque tolerance better 8 % acc. to ISO 5393	

2 Square drive 1/4"

Type	Article number
Square drive 1/4"	DS-2263730

4 Hexagonal quick release element B5,5

Type	Article number
Hexagonal quick release element B5,5	DS-2263715

7 Hexagonal quick release element D6,3

Type	Article number
Bit shaft precision-guide 13 mm	DS-2403705
Bit shaft precision-guide 24 mm	DS-2403710